



ALLWYN ENTERPRISE

UNIT-1:31, SHAYONA ESTATE, NEAR VADILAL ICE FACTORY,
TAVDIPURA, DUDHESHWAR ROAD, SHAHIBAUG,
AHMEDABAD-380 004, GUJARAT, INDIA.

E-mail: info@valvemanufacturer.in

DRN MASUM	DATE 05/09/2011	
--------------	--------------------	--

DOUBLE FLANGE CENTRIC DISC
TYPE BUTTER FLY VALVE.

DRG. NO : AE/DF-BFV-G/200-600

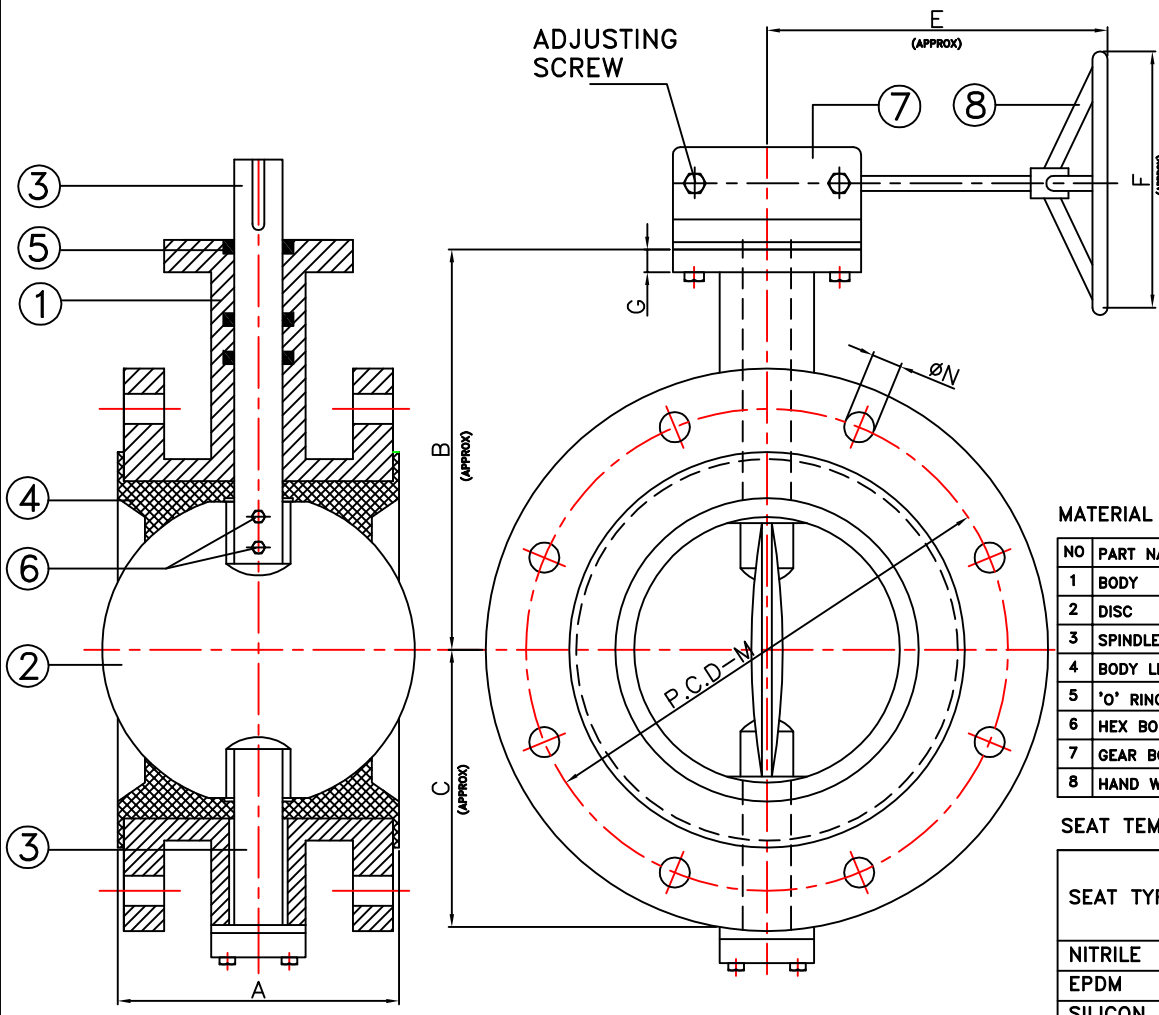

MATERIAL OF CONSTRUCTION

NO	PART NAME	MATERIAL
1	BODY	CAST IRON/CAST STEEL/S.S.304-316
2	DISC	CAST IRON/CAST STEEL/S.S.304-316
3	SPINDLE	SS 410/304/316
4	BODY LINING	NITRILE/E.P.D.M./SILICON/VITON/HYPALON
5	'O' RING	NITRILE / E.P.D.M.
6	HEX BOLT	S.S.304/316
7	GEAR BOX	CAST IRON
8	HAND WHEEL	M.S. FABRICATED

SEAT TEMPERATURE RANGE

SEAT TYPE	TEMPERATURE RANGE	
	Min.	Max.
NITRILE	-13°F(-25°C)	212°F(100°C)
EPDM	-13°F(-25°C)	250°F(120°C)
SILICON	-58°F(-50°C)	356°F(180°C)
VITON	-23°F(-5°C)	392°F(200°C)
HYPALON	-4°F(-20°C)	250°F(120°C)

NOTE : ALL DIMENSION ARE IN MM.

SIZE		A	B	C	E	F	G	FLANGE MOUNTING (I.S.O 5211)
MM	INCH							
200	8"	152	250	175	285	300	15	F10
250	10"	165	285	208	285	350	18	F10
300	12"	178	310	227	285	350	18	F10
350	14"	190	340	275	300	350	22	F12
400	16"	216	376	308	305	500	22	F14
450	18"	222	390	373	305	500	24	F14
500	20"	229	425	408	370	500	26	F16
600	24"	267	500	464	350	600	26	F16

O = NUMBER OF HOLES.

NOTE:-M,N,O AS PER REQUIREMENT

M = _____
N = _____
O = _____

TESTING

PRESSURE RATING	HYDROSTATIC SHELL TEST		HYDROSTATIC SEAT TEST	
	Kg/CM2	PSI	Kg/CM2	PSI
PN16	22	310	16	225
PN10	15	210	10	140
PN6	9	126	6	84

CONFORMITY TO CODES & STANDARDS

- 1) GENERAL DESIGN & MANUFACTURE :- BS 5155 / API 609 / EN 593 / IS 13095
- 2) VALVE FACE TO FACE DIMENSION :- BS 5155 / ISO 5752 / API 609
- 3) TOP FLANGE DRILLING :- ISO 5211
- 4) VALVE INSPECTION & TESTING :- BS 6755 Part - I / API 598 / EN 12266-1
- 5) FLANGE STANDARD CONFORMITY :- ANSI 150 / ANSI 125 / BS 10 TAB D & E
IS 6392 NP 0.6 / 1.0 / 1.6

THIS DRAWING IS PROPERTY OF ALLWYN ENTERPRISE.
ALLWYN ENTERPRISE RESERVES RIGHTS OF USE, CHANGE & MODIFY PRODUCT DESIGN OR PRODUCT WITHOUT PRIOR NOTICE.

CHECKED :-

APPROVED :-